

FPM-64 and FPM-64T MultiSync LCD Monitor 6.4" TFT Class Display

The FPM-64 and FPM-64T ["T" designating *Touch Screen*] are ruggedly built industrial display products suitable for factory floor environments. The mounting bezel is sealed to NEMA (National Electrical Manufacturers Association) specifications and provides a dust and liquid tight seal when installed in a suitable enclosure. The bezel is finished with a tough baked on powder coat that is resistant to scratches and most chemicals and will look good for years. Special colors and finishes are available.

Offering simple installation and easy setup, all FPM-64 series displays are plug compatible with your standard computer video card. Screen setup is simplified with digital side mounted controls [to avoid tampering] and On Screen Display . After setup all video settings are stored in the units non volatile-memory and will be retained during power down conditions.

The FPM-64 provides full screen display of VESA (Video Electronic Standards of America) resolutions of VGA (640x480), the LCD's native resolution. Incorporating a high quality LCD, FPM-64's are suitable for harsh lighting conditions and off angle viewing.

The FPM-64T is fitted with a high resolution analog resistive touch screen. Available either as a serial RS-232 interface or a PC bus card, the touch screen provides a mouse emulation, supporting Click, Double Click, and Click and Drag, including Right Click functionality!



IED Model FPM-64T 6.4" VGA Touch Screen Monitor

The ventilated chassis is formed from 16 Ga. (.062) Stainless Steel, for strength and corrosion resistance. For easy service the rear of the unit hinges down and where ever possible aircraft style vibration resistant fasteners are used for assembly.

The bezel is milled from .250" thick 6061 Aluminum plate. The radiused edge and corners are milled to reduce dust collection and give an attractive look to a very rugged package.

General Specifications: Models FPM-64 and FPM-64T

Liquid Crystal Display (LCD)

Display Size / Type	6.4" Diagonal / TFT Active Matrix
Active Area	5.14"(h) x 3.82"(v)
Pixel Format	640(h) x 480(v)
Brightness	300 Nits Typical
Contrast Ratio	100:1
Viewing Angle (Horizontal)	70 / 70 Deg
Viewing Angle (Vertical)	70 / 40 Deg.
Back Light Life	50,000 Hours (Half Life)
Colors Supported	256,000

Mechanical Construction

Bezel Outside Dimension	9.5"(h) x 7.0"(v)
Bezel Material	.250" 6061 Aluminum
Bezel Finish	Black Powder Coat
Front End Construction	NEMA 4/12
Chassis Depth (Behind Cabinet Door)	2.125"
Chassis Construction	16 Ga. Stainless Steel

Environmental

Operating Temp.	0-50 C
Storage Tem	0-60 C
Operating Humidity	10-95% Non Condensing
Storage Humidity	10-95% Non Condensing

Electrical

Input Voltage	12 VDC Nominal
Input Wattage	25 Watts Typical
Certification	CE Pending

Touch Screen

Analog Resistive	5 Wire
Touch Screen Resolution	400 ppi
Screen Finish	Anti Reflective
Chemical Resistance	Acetone, MEK, Mineral spirits, Isopropyl alcohol, Methylene chloride
Estimated Life	>35 Million touches in one location
Computer Interface	Serial RS-232 (Standard) PC-Bus (Optional)
Electrostatic Protection	IEC 801-2

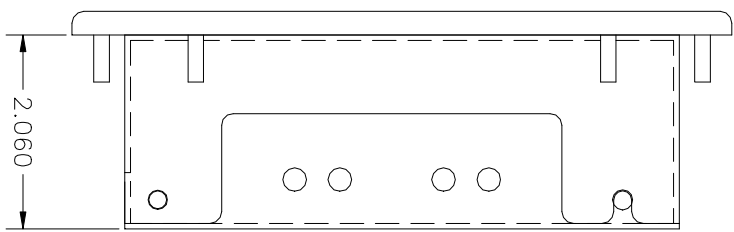
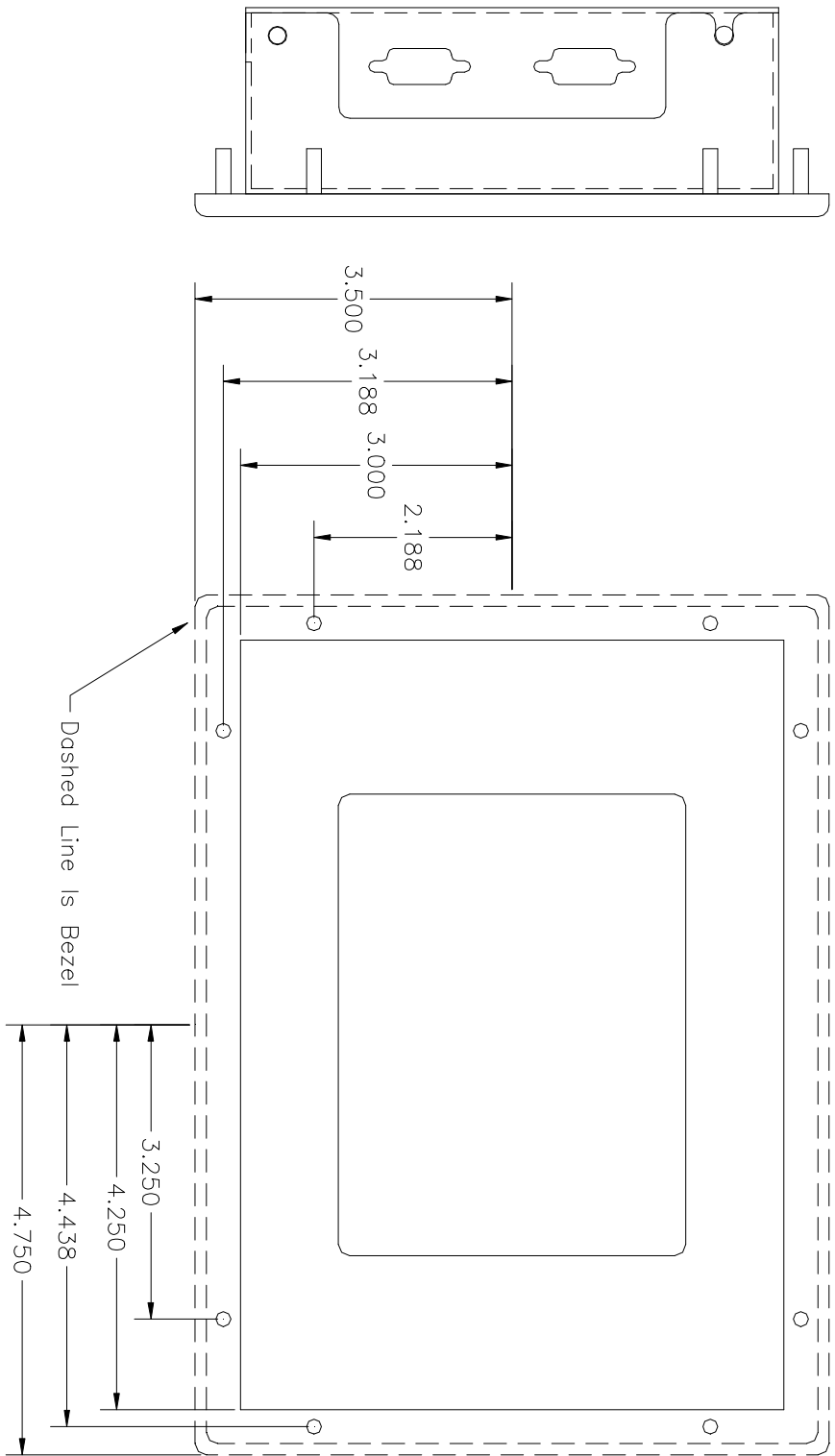

Screen Adjustments

Model FPM-64(T) Panel Cut Out and Mounting Information

Standard LCD Monitor Configurations

Part Number	Delivery	Description	VGA	SVGA	XGA	SXGA
FPM-64	S	6.4" LCD Panel Mount	*			
FPM-64T	S	6.4" LCD Panel Mount Touch	*			
FPM-64/RM	2	6.4" LCD 19" Rack Mount	*			
FPM-64T/RM	2	6.4" LCD 19" Rack Mount Touch	*			
FPM-104	S	10.4" LCD Panel Mount	*			
FPM-104T	S	10.4" LCD Panel Mount Touch	*			
FPM-104/RM	2	10.4" LCD 19" Rack Mount	*			
FPM-104T/RM	2	10.4" LCD 19" Rack Mount Touch	*			
FPM-120/OF	S	12.1" OEM Chassis Mount		*		
FPM-120	S	12.1" LCD Panel Mount		*		
FPM-120T	S	12.1" LCD Panel Mount Touch		*		
FPM-120/RM	2	12.1" LCD 19" Rack Mount		*		
FPM-120T/RM	2	12.1" LCD 19" Rack Mount Touch		*		
FPM-140/OF	S	14" OEM Chassis Mount	*	*	*	
FPM-140	S	14" LCD Panel Mount	*	*	*	
FPM-140T	S	14" LCD Panel Mount Touch	*	*	*	
FPM-140/RM	S	14" LCD 19" Rack Mount	*	*	*	
FPM-140T/RM	S	14" LCD 19" Rack Mount Touch	*	*	*	
FPM-150/OF	S	15" LCD OEM Chassis Mount	*	*	*	
FPM-150	S	15" LCD Panel Mount	*	*	*	
FPM-150T	S	15" LCD Panel Mount Touch	*	*	*	
FPM-150/RM	2	15" LCD 19" Rack Mount	*	*	*	
FPM-150T/RM	2	15" LCD 19" Rack Mount Touch	*	*	*	
FPM-180	S	18" LCD Panel Mount	*	*	*	*
FPM-180T	S	18" LCD Panel Mount Touch	*	*	*	*
FPM-180/RM	S	18" LCD 19" Rack Mount	*	*	*	*
FPM-180T/RM	S	18" LCD 19" Rack Mount Touch	*	*	*	*
FPM-200	2	20" LCD Panel Mount	*	*	*	*
FPM-200T	2	20" LCD Panel Mount Touch	*	*	*	*

Monitor Accessories

Stainless Bezel	4 Weeks	304 Stainless Steel Bezel For NEMA 4X
SVGA -25	S	25 Foot High Frequency Video Cable
SVGA -50	S	50 Foot High Frequency Video Cable
RS232-25	S	25 Serial Touch Cable
RS232-50	S	50 Serial Touch Cable

This document is available at our web site

IED Web Address

<http://www.IndustrialDisplays.com>

Industrial Electronic Devices, Inc
Telephone 908.806.2255

15 Minneakoning Rd, Suite 105
Fax 908.806.3376

Flemington, NJ 08822
Email info@IndustrialDisplays.com